

**TYPICAL CROSS SECTION - N63 MAINLINE  
(TYPE 2 SINGLE CARRIAGEWAY)**

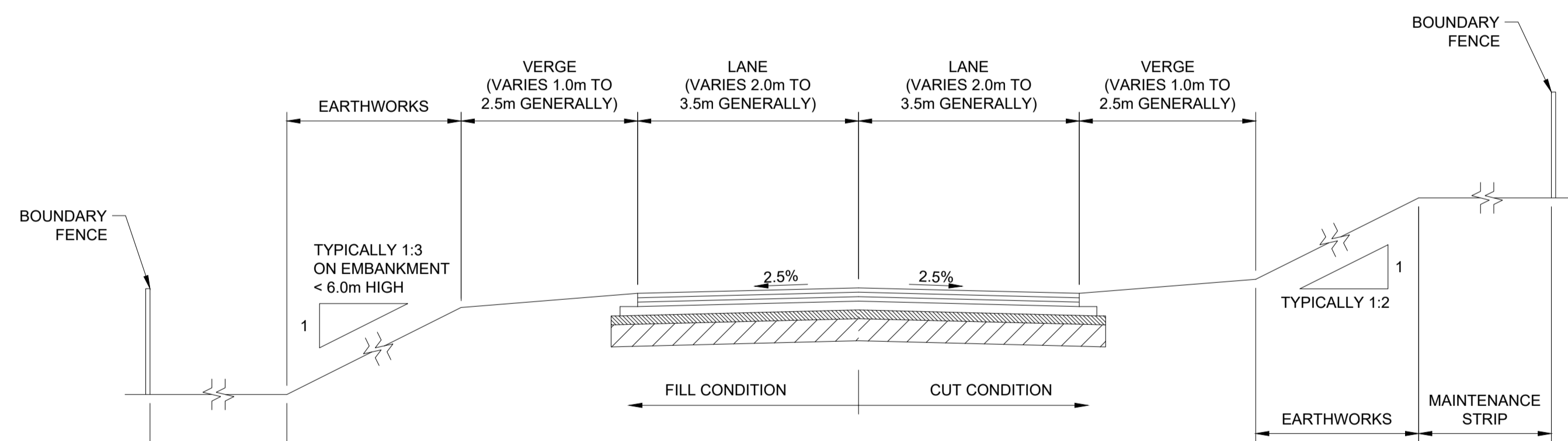

**TYPICAL CROSS SECTION - LOCAL ROADS**

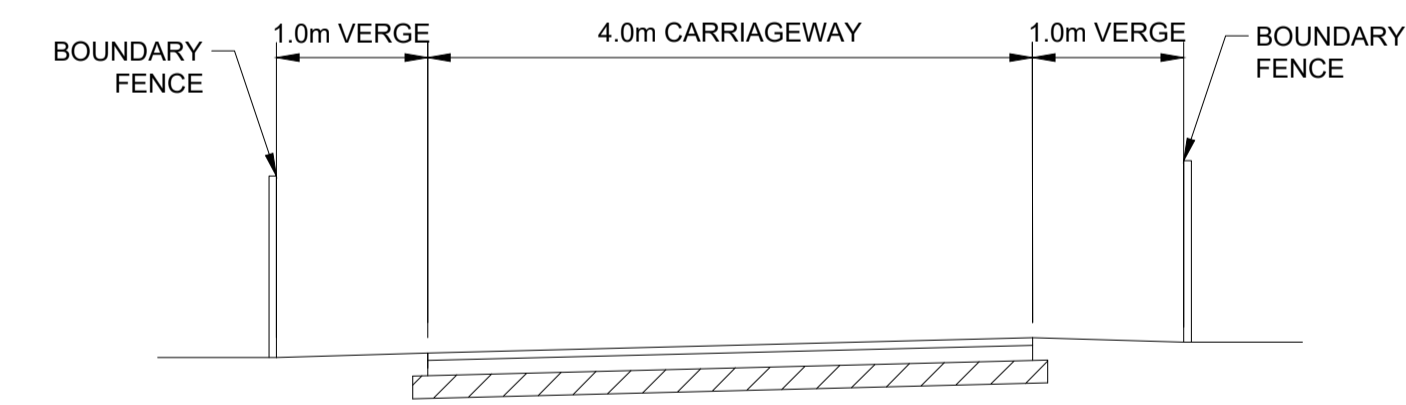

**TYPICAL CROSS SECTION - ACCESS ROADS**

**SECTION**

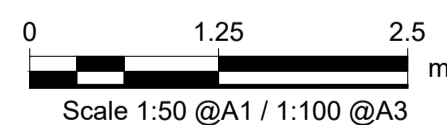

No.	Revision	Date	By	Chk'd	App'd

**Roughan & O'Donovan-AECOM Alliance**

**ROD AECOM**

AECOM Roughan & O'Donovan  
Adelphi Plaza  
Georges Street Upper  
Dun Laoghaire  
Co. Dublin  
Ireland  
T +353 (0)1 238 3100  
www.aecom.com

Roughan & O'Donovan  
Arena House  
Arena Road  
Sandyford  
Dublin 18  
Ireland  
T +353 (0)1 294 0800  
www.rod.ie

Drawn	Designed	Checked	Approved	Suitability Code - Description
AC	LB	LB	EG	S3 - Review & Comment

Project Title		N63 LISS TO ABBEY REALIGNMENT SCHEME					
Drawing Title		TYPICAL ROAD CROSS SECTIONS SHEET 1 OF 2					
Project	Originator	Phase	Series	Type	Dept	Number	
N63	ACM	PH03	0100	DR	HW	0101	
Scale:	1:50 @A1 / 1:100 @A3	Date:	21.12.2021	Job No:	60597858	Rev:	P02

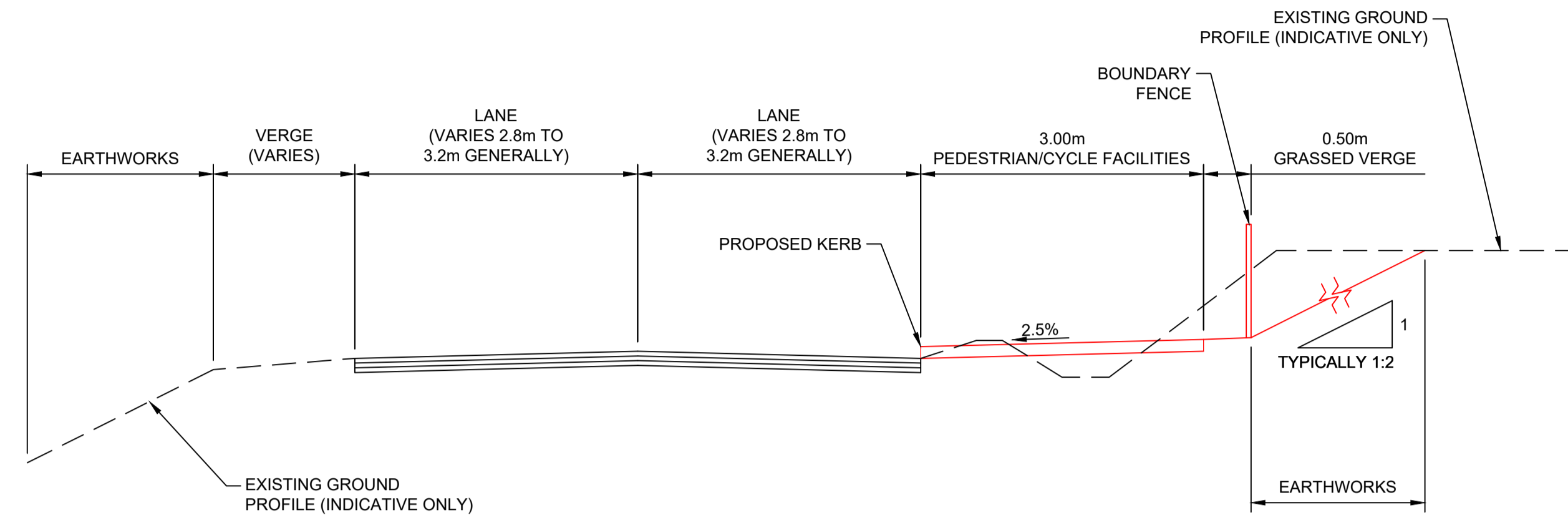

**TYPICAL CROSS SECTION - EXISTING N63  
(PROPOSED PEDESTRIAN/CYCLE FACILITIES - AGRICULTURAL LAND)**

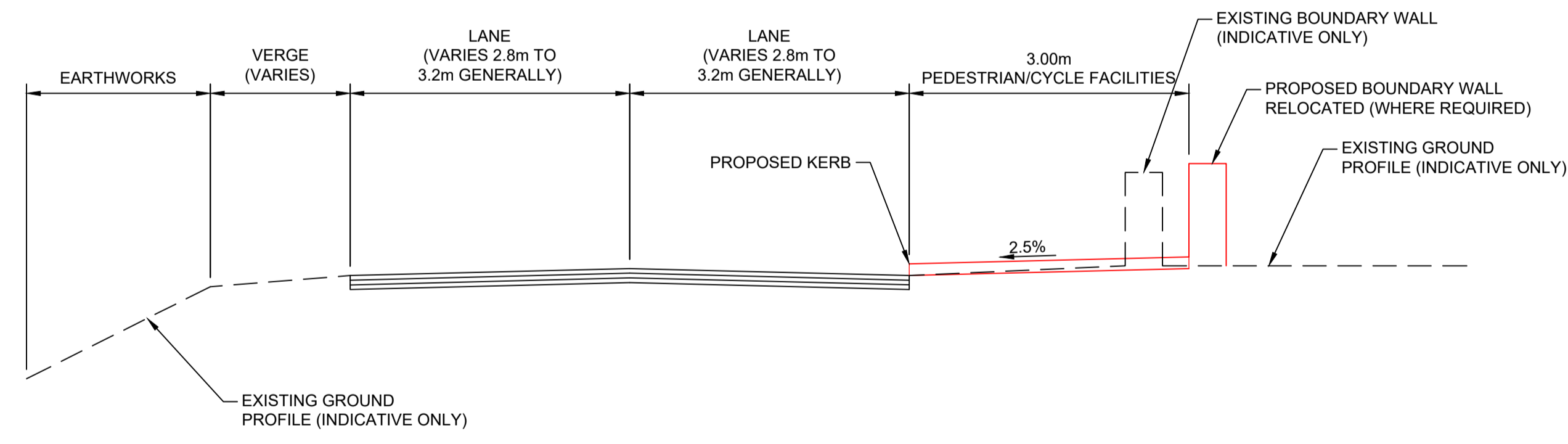

**TYPICAL CROSS SECTION - EXISTING N63  
(PROPOSED PEDESTRIAN/CYCLE FACILITIES - RESIDENTIAL PROPERTIES)**

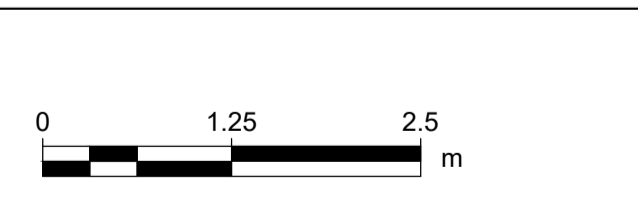

	<table border="1"> <thead> <tr> <th>No.</th> <th>Revision</th> <th>Date</th> <th>By</th> <th>Chk'd</th> <th>App'd</th> </tr> </thead> <tbody> <tr><td> </td><td> </td><td> </td><td> </td><td> </td><td> </td></tr> <tr><td> </td><td> </td><td> </td><td> </td><td> </td><td> </td></tr> <tr><td> </td><td> </td><td> </td><td> </td><td> </td><td> </td></tr> <tr><td> </td><td> </td><td> </td><td> </td><td> </td><td> </td></tr> <tr><td> </td><td> </td><td> </td><td> </td><td> </td><td> </td></tr> <tr><td> </td><td> </td><td> </td><td> </td><td> </td><td> </td></tr> <tr><td> </td><td> </td><td> </td><td> </td><td> </td><td> </td></tr> <tr><td> </td><td> </td><td> </td><td> </td><td> </td><td> </td></tr> <tr><td> </td><td> </td><td> </td><td> </td><td> </td><td> </td></tr> </tbody> </table>	No.	Revision	Date	By	Chk'd	App'd																																																							<p><b>Roughan &amp; O'Donovan-AECOM Alliance</b></p> <p><b>ROD</b> ROUGHAN &amp; O'DONOVAN</p> <p><b>AECOM</b></p> <p>AECOM Roughan &amp; O'Donovan Adelphi Plaza Georges Street Upper Dun Laoghaire Co. Dublin Ireland T +353 (0)1 238 3100 www.aecom.com</p> <p>Roughan &amp; O'Donovan Arena House Arena Road Sandyford Dublin 18 Ireland T +353 (0)1 294 0800 www.rod.ie</p>	<p>Project Title: N63 LISS TO ABBEY REALIGNMENT SCHEME</p>
		No.	Revision	Date	By	Chk'd	App'd																																																								
<table border="1"> <thead> <tr> <th>Drawn</th> <th>Designed</th> <th>Checked</th> <th>Approved</th> <th>Suitability Code - Description</th> </tr> </thead> <tbody> <tr> <td>AC</td> <td>LB</td> <td>LB</td> <td>EG</td> <td>S3 - Review &amp; Comment</td> </tr> </tbody> </table>	Drawn	Designed	Checked	Approved	Suitability Code - Description	AC	LB	LB	EG	S3 - Review & Comment	<p>Drawing Title: TYPICAL ROAD CROSS SECTIONS SHEET 2 OF 2</p> <table border="1"> <thead> <tr> <th>Project</th> <th>Originator</th> <th>Phase</th> <th>Series</th> <th>Type</th> <th>Dept</th> <th>Number</th> </tr> </thead> <tbody> <tr> <td>N63</td> <td>ACM</td> <td>PH03</td> <td>0100</td> <td>DR</td> <td>HW</td> <td>0102</td> </tr> </tbody> </table> <p>Scale: 1:50 @A1 / 1:100 @A3 Date: 21.12.2021 Job No: 60597858 Rev: P02</p>	Project	Originator	Phase	Series	Type	Dept	Number	N63	ACM	PH03	0100	DR	HW	0102																																						
Drawn	Designed	Checked	Approved	Suitability Code - Description																																																											
AC	LB	LB	EG	S3 - Review & Comment																																																											
Project	Originator	Phase	Series	Type	Dept	Number																																																									
N63	ACM	PH03	0100	DR	HW	0102																																																									



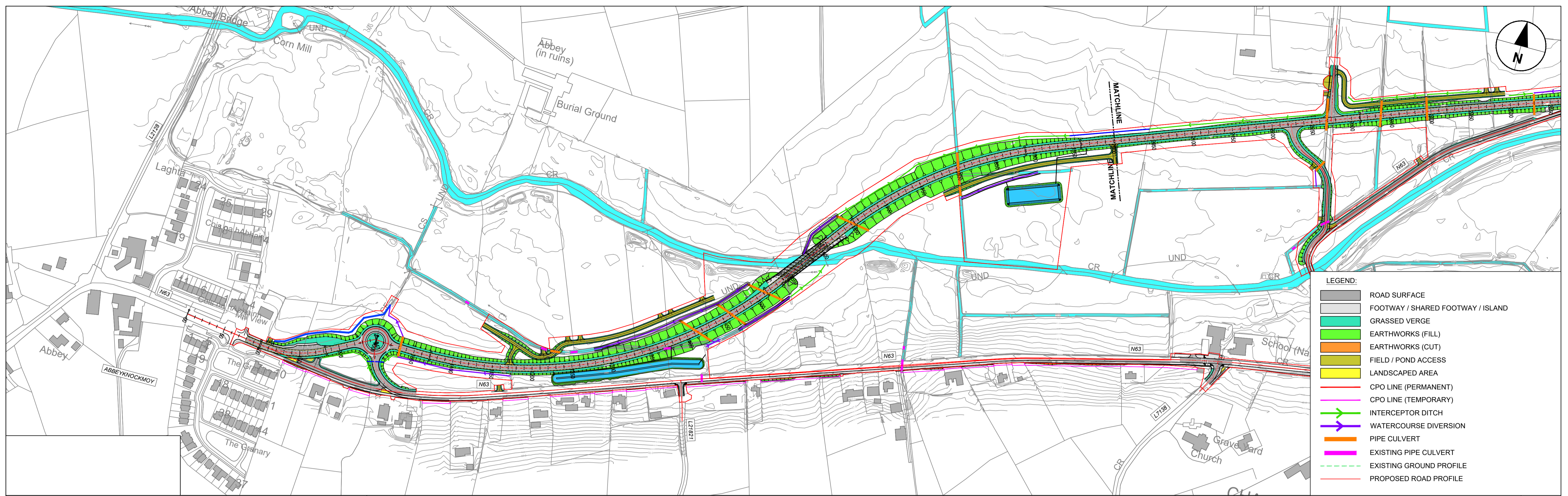

- LEGEND:**
- ROAD SURFACE
  - FOOTWAY / SHARED FOOTWAY / ISLAND
  - GRASSED VERGE
  - EARTHWORKS (FILL)
  - EARTHWORKS (CUT)
  - FIELD / POND ACCESS
  - LANDSCAPED AREA
  - CPO LINE (PERMANENT)
  - CPO LINE (TEMPORARY)
  - INTERCEPTOR DITCH
  - WATERCOURSE DIVERSION
  - PIPE CULVERT
  - EXISTING PIPE CULVERT
  - EXISTING GROUND PROFILE
  - PROPOSED ROAD PROFILE

**ALIGNMENT\_A01 LONGSECTION**  
SCALE: H 1:2500, V 1:250

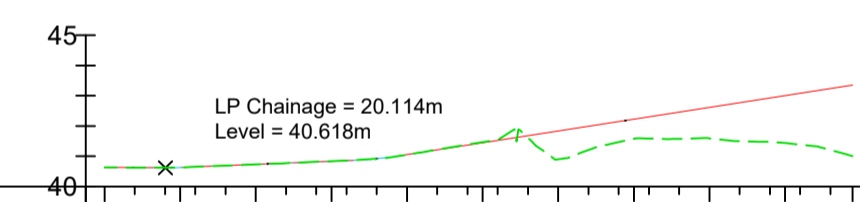

CHAINAGE	EXISTING LEVELS	PROPOSED LEVELS	LEVEL DIFFERENCE
00.000	40.634	40.634	0.000
25.000	40.632	40.627	0.005
50.000	40.731	40.730	0.001
75.000	40.840	40.833	0.007
100.000	41.055	41.053	0.002
125.000	41.465	41.442	0.023
150.000	40.898	41.832	-0.934
175.000	41.581	42.221	-0.640
200.000	41.588	42.811	-1.223
225.000	41.441	43.001	-1.560
247.357	41.009	43.348	-2.339

HORIZONTAL ALIGNMENT	VERTICAL ALIGNMENT	SUPERELEVATION
L=98.461m	G=-0.10% (L=13.00m), G=0.41% (L=124.00m), G=1.56% (L=13.00m)	-2.500% to 2.500%
R=136.00m (L=84.52m)	G=-0.78% (L=232.75m)	-2.500% to 2.500%
L=64.376m	G=1.88% (L=97.87m)	-2.500% to 2.500%
	L=98.510m (K=37.00)	-2.500% to 2.500%
	L=392.98m (K=100.00)	-2.500% to 2.500%
	G=-2.05% (L=67.73m)	-2.500% to 2.500%
	L=103.473m (K=37.00)	-2.500% to 2.500%
	G=0.75% (L=259.15m)	-2.500% to 2.500%

**ALIGNMENT\_A02 LONGSECTION**  
SCALE: H 1:2500, V 1:250

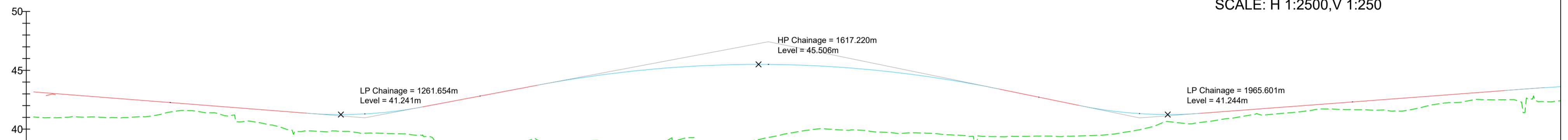

CHAINAGE	EXISTING LEVELS	PROPOSED LEVELS	LEVEL DIFFERENCE
1000.000	41.037	43.173	2.136
1025.000	40.995	42.977	1.982
1050.000	41.048	42.782	1.734
1075.000	40.968	42.587	1.618
1100.000	41.112	42.391	1.280
1125.000	41.584	42.196	0.612
1150.000	41.389	42.001	0.612
1175.000	40.609	41.805	1.196
1200.000	40.381	41.610	1.229
1225.000	39.798	41.415	1.617
1250.000	39.708	41.280	1.492
1275.000	39.717	41.285	1.548
1300.000	39.642	41.440	1.798
1325.000	39.485	41.783	2.298
1350.000	38.753	42.248	3.496
1375.000	38.880	42.719	3.839
1400.000	38.815	43.189	4.374
1425.000	39.173	43.659	4.486
1450.000	38.972	44.108	5.135
1475.000	39.034	44.485	5.461
1500.000	38.833	44.819	5.986
1525.000	38.782	45.081	6.299
1550.000	39.119	45.280	6.161
1575.000	45.417	45.417	0.000
1600.000	39.671	45.481	5.810
1625.000	39.290	45.503	6.213
1650.000	39.771	45.452	5.681
1675.000	40.020	45.339	5.319
1700.000	39.933	45.103	5.200
1725.000	39.732	44.925	5.193
1750.000	39.692	44.624	4.932
1775.000	39.544	44.261	4.717
1800.000	39.402	43.835	4.434
1825.000	39.353	43.348	3.994
1850.000	39.401	42.835	3.435
1875.000	39.375	42.323	2.948
1900.000	39.456	41.825	2.369
1925.000	39.671	41.466	1.796
1950.000	40.150	41.277	1.126
1975.000	40.542	41.286	0.744
2000.000	40.650	41.397	0.747
2025.000	41.010	41.584	0.575
2050.000	41.219	41.771	0.552
2075.000	41.436	41.958	0.523
2100.000	41.720	42.145	0.425
2125.000	41.650	42.332	0.683
2150.000	41.630	42.519	0.889
2175.000	41.703	42.706	1.003
2200.000	42.205	42.893	0.689
2225.000	42.480	43.080	0.600
2250.000	42.503	43.267	0.765
2275.000	42.865	43.448	0.583

HORIZONTAL ALIGNMENT	VERTICAL ALIGNMENT	SUPERELEVATION
L=98.461m	G=-0.78% (L=232.75m)	-2.500% to 5.000%
R=510.00m (L=443.24m)	G=1.88% (L=97.87m)	-2.500% to 5.000%
L=70.00m	L=392.98m (K=100.00)	-2.500% to 5.000%
A=188.94m (L=70.00m)	G=-2.05% (L=67.73m)	-2.500% to 5.000%
R=510.00m (L=234.43m)	L=103.473m (K=37.00)	-2.500% to 5.000%
L=352.180m	G=0.75% (L=259.15m)	-2.500% to 5.000%

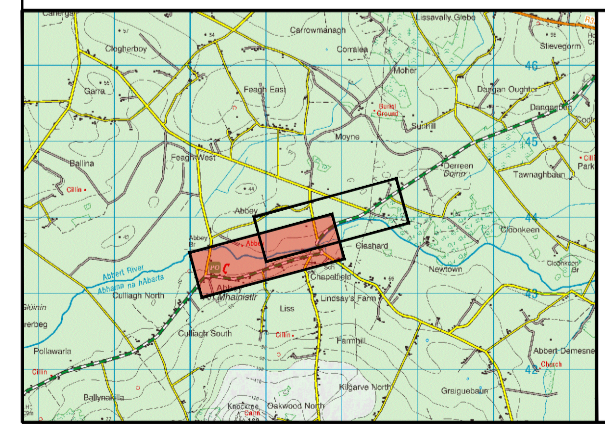
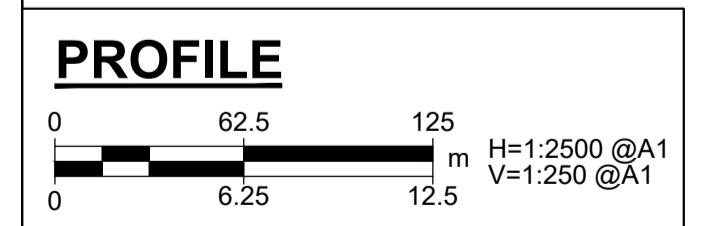

No.	Revision	Date	By	Chkd	App'd

**Roughan & O'Donovan-AECOM Alliance**

**ROD AECOM**

AECOM Roughan & O'Donovan  
Adelphi Plaza  
Georges Street Upper  
Dun Laoghaire  
Co. Dublin  
Ireland  
T +353 (0)1 238 3100  
www.aecom.com

Roughan & O'Donovan  
Arena House  
Arena Road  
Sandyford  
Dublin 18  
Ireland  
T +353 (0)1 234 0800  
www.rod.ie

Drawn: AC, Designed: LB, Checked: LB, Approved: EG, Suitability Code - Description: S3 - Review & Comment

Project Title		N63 LISS TO ABBEY REALIGNMENT SCHEME			
Drawing Title		MAINLINE - PLAN AND PROFILE SHEET 1 OF 2			
Project	Originator	Phase	Series	Type	Dept
N63	ACM	PH03	0100	DR	HW
Number	Date		Job No.	Rev.	
	21.12.2021		60597858	P02	



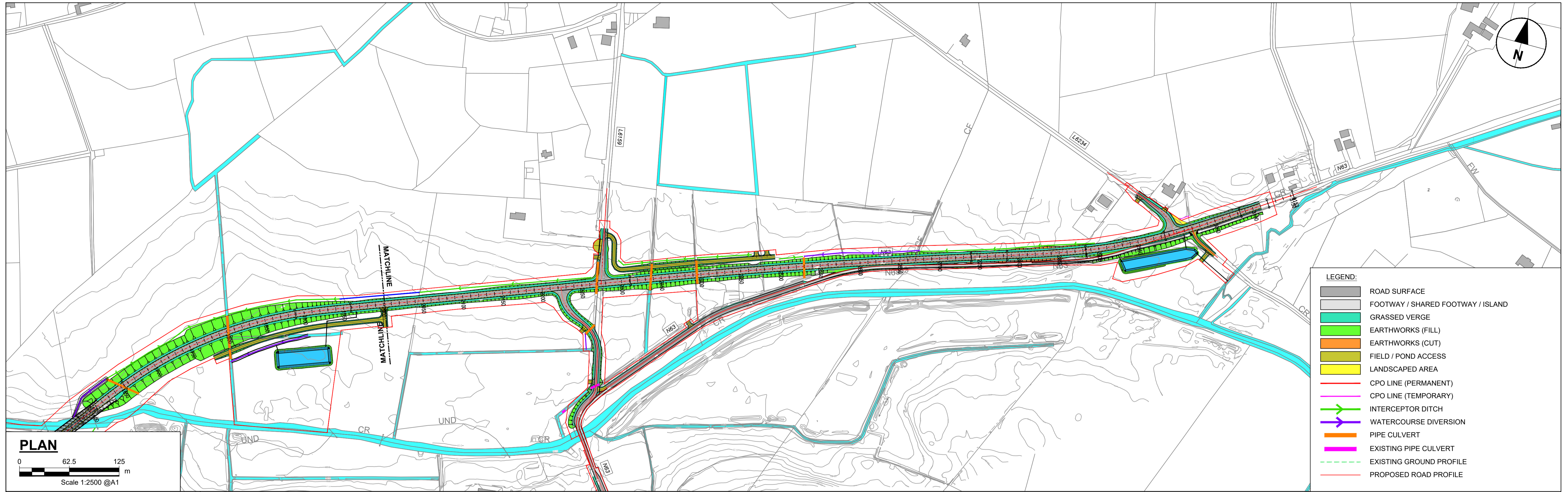

**LEGEND:**

- ROAD SURFACE
- FOOTWAY / SHARED FOOTWAY / ISLAND
- GRASSED VERGE
- EARTHWORKS (FILL)
- EARTHWORKS (CUT)
- FIELD / POND ACCESS
- LANDSCAPED AREA
- CPO LINE (PERMANENT)
- CPO LINE (TEMPORARY)
- INTERCEPTOR DITCH
- WATERCOURSE DIVERSION
- PIPE CULVERT
- EXISTING PIPE CULVERT
- EXISTING GROUND PROFILE
- PROPOSED ROAD PROFILE

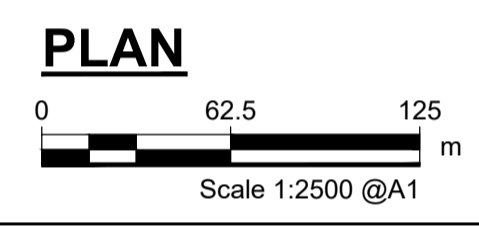

**ALIGNMENT\_A02 LONGSECTION**  
SCALE: H 1:2500, V 1:250

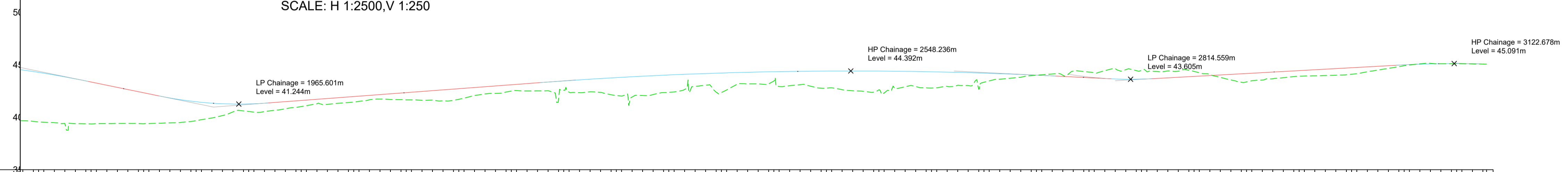

CHAINAGE	EXISTING LEVELS	PROPOSED LEVELS	LEVEL DIFFERENCE	HORIZONTAL ALIGNMENT	VERTICAL ALIGNMENT	SUPERELEVATION
1775.000	38.54	44.261	4.717	=510.00m L=234.43m	G=-2.05% (-194.2)	5.000% -2.500%
1800.000	38.40	43.835	4.434			
1825.000	38.353	43.848	3.994	A=188.94m L=70.00m	L=103.473m K=37.00	5.000% -2.500%
1850.000	38.401	42.835	3.435			
1875.000	38.375	42.323	2.948	L=352.180m	G=0.75% (1453.7)	5.000% -2.500%
1900.000	38.459	41.825	2.369			
1925.000	38.671	41.466	1.786	R=8160.00m L=428.51m	L=490.60m K=395.51	5.000% -2.500%
1950.000	40.159	41.277	1.126			
1975.000	40.542	41.256	0.714	L=45.218m	G=-0.49% (-1283.0)	-2.500% -5.000%
2000.000	40.659	41.397	0.737			
2025.000	41.010	41.594	0.575	A=266.98m L=99.00m	L=38.555m K=37.00	-2.500% -5.000%
2050.000	41.219	41.771	0.552			
2075.000	41.439	41.569	0.523	R=720.00m L=100.67m	G=0.55% (1482.7)	-5.000% -2.500%
2100.000	41.729	42.145	0.425			
2125.000	41.659	42.332	0.683	A=266.98m L=99.00m	L=80.44m K=100.00	5.000% -2.500%
2150.000	41.630	42.519	0.889			
2175.000	41.703	42.706	1.003	R=3580.36m L=33.54m	G=1.25% (1282.4)	5.000% -2.500%
2200.000	42.205	42.893	0.688			
2225.000	42.489	43.080	0.590			
2250.000	42.500	43.267	0.765			
2275.000	42.566	43.448	0.883			
2300.000	42.413	43.613	1.200			
2325.000	42.059	43.762	1.703			
2350.000	42.00	43.895	1.894			
2375.000	42.358	44.012	1.655			
2400.000	42.927	44.114	1.186			
2425.000	42.341	44.200	1.858			
2450.000	42.500	44.392	1.892			
2475.000	42.599	44.383	1.788			
2500.000	42.600	44.324	1.724			
2525.000	43.081	44.362	1.275			
2550.000	42.763	44.385	1.622			
2575.000	42.500	44.392	1.892			
2600.000	42.599	44.383	1.788			
2625.000	42.891	44.359	1.467			
2650.000	42.763	44.317	1.548			
2675.000	43.030	44.281	1.231			
2700.000	43.323	44.188	0.865			
2725.000	43.700	44.100	0.398			
2750.000	43.988	43.997	0.009			
2775.000	43.984	43.878	-0.116			
2800.000	44.296	43.754	-0.532			
2825.000	44.610	43.633	-0.976			
2850.000	44.453	43.619	-0.833			
2875.000	44.396	43.743	-0.652			
2900.000	44.354	43.881	-0.473			
2925.000	43.794	44.018	0.234			
2950.000	43.350	44.156	0.806			
2975.000	43.890	44.430	0.537			
3000.000	43.960	44.658	0.698			
3025.000	44.083	44.705	0.623			
3050.000	44.470	44.843	0.364			
3075.000	44.898	44.977	0.081			
3100.000	45.119	45.065	-0.054			
3125.000	45.088	45.091	0.005			
3150.000	45.080	45.054	-0.028			

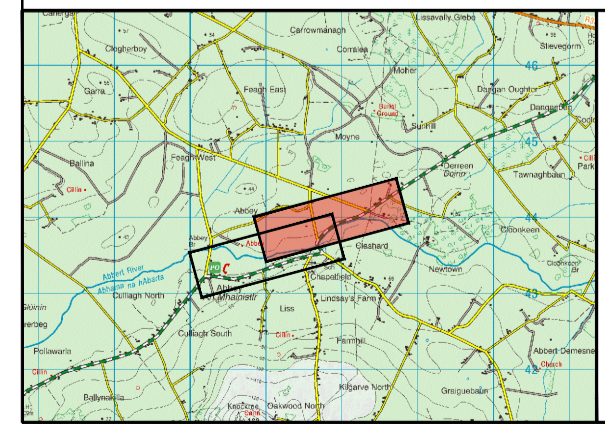
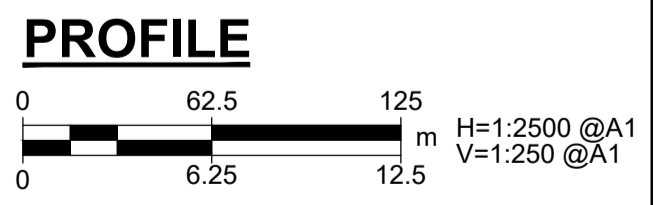

No.	Revision	Date	By	Chk'd	App'd

**Roughan & O'Donovan-AECOM Alliance**

**ROD AECOM**

AECOM Roughan & O'Donovan  
Adelphi Plaza  
Georges Street Upper  
Dun Laoghaire  
Co. Dublin  
Ireland  
T +353 (0)1 238 3100  
www.aecom.com

Roughan & O'Donovan  
Arena House  
Arena Road  
Sandyford  
Dublin 18  
Ireland  
T +353 (0)1 294 0800  
www.rod.ie

Drawn: AC, Designed: LB, Checked: LB, Approved: EG, Suitability Code - Description: S3 - Review & Comment

Project Title		N63 LISS TO ABBEY REALIGNMENT SCHEME			
Drawing Title		MAINLINE - PLAN AND PROFILE SHEET 2 OF 2			
Project	Originator	Phase	Series	Type	Dept
N63	ACM	PH03	0100	DR	HW
Number					
Scale:	AS SHOWN	Date:	21.12.2021	Job No:	60597858
				Rev:	P02